

# Eco Stage 80W Gobo Projector

( 80W white LED )



## User Manual

Please read this user manual before using this product



## I.Checking before using

No.	Item	Q.	Unit
1	80W LOGO Light	1	Piece
2	Handle	1	Piece
3	Handle Screw	2	Piece
4	Rubber Mat	2	Piece
5	Power Cable	1	Piece
6	User Manual	1	Piece
7	Hook	Need to purchase	
8	Safety Rope		
9	DMX Cable		

★For security reasons and in accordance with the terms,reassemble or modify the product is not allowed without permission. Please note that due to human damage caused by improper use of the product,will break the warranty qualification. Moreover, the unprofessional operation may lead to short circuits, burns or electric shock, and so on.

★This device has been full inspection before shipping. For your safety, please operate it according the User Manual.

★If any damage caused by improper operation will result in the termination of the warranty claims. The manufacturer does not accept any responsibility of property damage due to improper operation or personal injury due to non-compliance with the operating instructions.

★Keep the manual in a safe place for future reference as well as after the product sale,lease,etc..

★Note: Based on product improvements,specification may change,without notice.Changes in product specifications related rights reserved.

★Note: This machine is a mechanical positioning, slight noise when start or reset is normal.

## II.Safety Instruction



1. When opening the packing,take all accessories out,and remove the light to a horizontal table for good operation. First check whether the accessories are complete,then check carefully whether the whole light has no damage. If there is any damage,please contact us as soon as possible.
2. AC Power:Check whether the local power supply is accordance with the requirements of the product rated voltage.
3. The product is only suitable for indoor working environment. The light should keep dry,keep away from wet, overheat or dusty environment. Don't come into contact with water and other liquids to prevent or reduce the risk of electric shock or fire.
4. Please do not install the light directly on the surface of the combustible substance.
5. The people who install,operate and maintain of light professional certificate required.
6. When there are faults of the light, please stop using the light immediately. Don't try to repair,please contact the nearest authorized technical assistance center,if the parts damage, always use the same type of parts replaced.
7. Don't touch any electrical wiring in the process of operation to prevent the risk of electric shock.
8. To make sure the light working environment temperature, the highest do not exceed 40 °C,the lowest do not exceed - 20 °C.
9. Under the stable cooling working situation, the highest temperature of the housing of the light can reach 80 °C,please do not touch.
10. The light is design according to the type of electric shock protection. The light should be use in good connection grounding power system and the earth sign port of the light should be connected to the installing fixtures.
11. Do not use the damage of the insulating layer wire and also do not use the

power cord overlap on the other wire. When not in use or clean the light, please disconnect the power, don't pull the plug in hard or just drag the wires.

12. There are no components inside for maintenance. Before start operation the light, please check whether all of the shell is installed. In the case of the shell open used the light is prohibited.

Note: Under any installation, maintenance and clean the light, please confirm that has cut off the power cord!

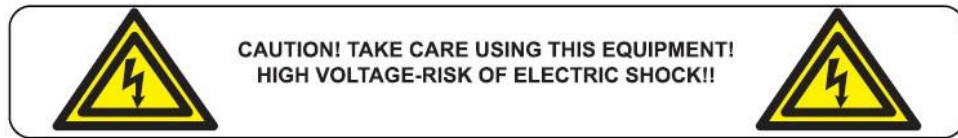

### III. Outlook Details:

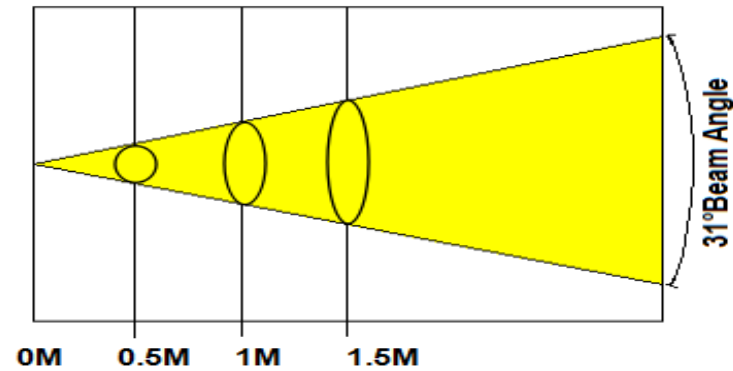
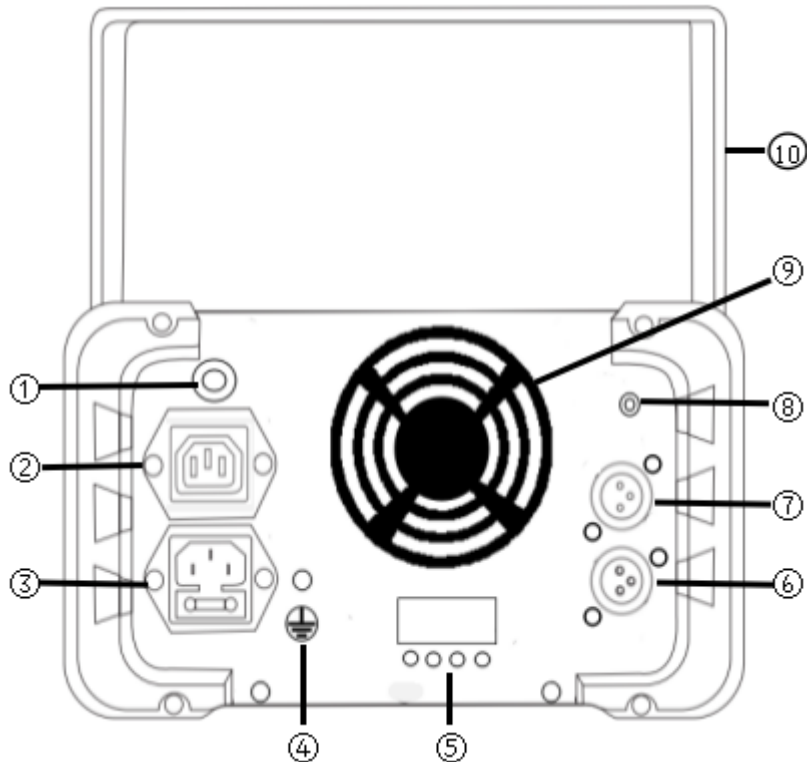

### XIII. Product maintenance and cleaning

**Please note the following information when testing this product:**

- ★All the screws and components of the installation must be tightly connected;
- ★The housing, lens, static parts and installation site can not be deformed;
- ★Any abrasion on power cable is unacceptable.
- ★The installation and use of the product must be carried out by a trained professional and technical person, must ensure that the exclusion of security risks.

#### **Notice: Power OFF before maintenance!**

It is important to keep the fixture clean, not only to keep the light output at maximum brightness, but also to extend its service life. It is recommended to use high-quality professional glass cleaner and a soft cloth to clean, any alcohol or chemical solvents is not allowed during the cleaning. The inside of the lamp and the fan should be cleaned by vacuum cleaner at least one time quarterly.

### XII. Product specification

## ●Fixture:

- ★International DMX protocol. Master/Slave mode;
- ★LED display,easy to control;
- ★Projector logo clear,logo could changeable;
- ★0-100% linear dimmer, and high speed strobe;
- ★fan cooling,extent the led work life;
- ★3 angle lens optional:23°/31°/42°;
- ★IR remote control;
- ★Channel: 3CH;
- ★Gobo size: 46.5 mm outside, 40 mm image

## ●Technical parameter:

- ★Voltage:AC100-240V/50-60Hz
- ★Fuse:F3AL250V
- ★Power consumption:120W
- ★Light source:80W white led
- ★N.W.:3.6KG
- ★G.W.:4.05KG
- ★Package size: 29\*28\*25CM(1piece)

## ●Optics parameter:

Angel	Diameter			Lumin		
	0.5M	1M	1.5M	1M	2M	5M
23°	Φ25CM	Φ50CM	Φ75CM	37700Lux	8750Lux	1253Lux
31°	Φ29CM	Φ59CM	Φ89CM	23000Lux	5450Lux	800Lux
42°	Φ45CM	Φ89CM	Φ133CM	12520Lux	2970Lux	447Lux

◆3 angel lens optional:23°, 31°, 42°. If client haven't mentioned which angel would like to choose, we will send light out with 31°lens.

No.	Function
①	Safety eye

②	POWER OUTPUT
③	POWER INPUT AC100-240V 50-60HZ
④	Ground
⑤	LED Display
⑥	DMX IN
⑦	DMX OUT
⑧	MIC
⑨	Cool Fan
⑩	Handle

## IV.LED Display

### FUNCTION SETTING

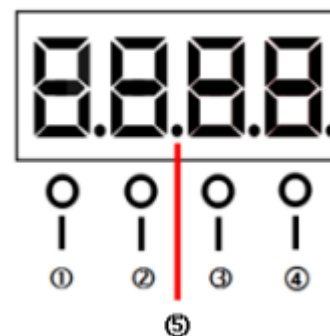

Item	NO.	Text	Function
Button:	①	MENU	Enter Menu setting
	②	▼	Next Menu
	③	▲	Last Menu
	④	ENTER	Enter setting/Confirm
LED:	⑤		Indicated LED

## V.Installation

1. For more safety,install position should stay away from walkways, seating areas, or somewhere man could reach without tool;
2. Before hanging products, be sure to install position can withstand 10 times the weight of the product;

3. Installation must be with secondary-safety,such safety rope;
4. When hanging, the removal or repair of this product,stand under the mount point is prohibited;
5. Make sure that the product should be installed away from combustible material at least 0.5 m;
6. Be sure to finish all install steps before power on the light;
7. Install steps:

7.1. The clamp install to the handle, and need to do secondary protection with safety rope. Clamp and safety rope could purchase from our company.

7.2. The clamp fix to the light,then lock the light by clockwise rotation. Finally,confirm the lock is working.

Below picture for reference.

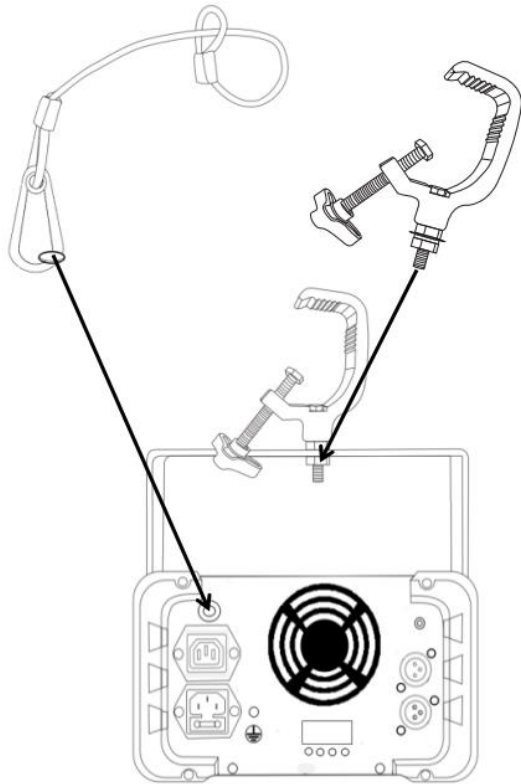

## X. DMX channel instruction

CH	Function	Value			Description
1	Dimmer	000	-	255	0-100% Dimmer
2	Strobe	000	-	007	NO function
		008	-	247	Strobe,slow to fast
		248	-	255	Sound random strobe
3	Rotation	000	-	009	Stop
		010	-	120	Anticlockwise,fast to slow
		121	-	134	Stop
		135	-	245	Clockwise,slow to fast
		246	-	255	Stop

## XI. How to replace the logo

Remove screw (No.①), turn the iron plate(No.2) 90°. Then we could take out the logo plate,see

Put logo into logo plate(No.③),use the ring(No.④) to keep the logo panel stable.



## IX. DMX Control

If you want to use the DMX controller to control the fixture, DMX address must be set to 1-512.

Press “MENU” button, UP OR DOWN to choose “8888”, Press “ENTER” button to enter DMX mode. When fixture connected to the controller, NO.5 LED (on led display) will turn on automatically, that means the light is connected with controller successfully.

Please connect the fixture as below picture.

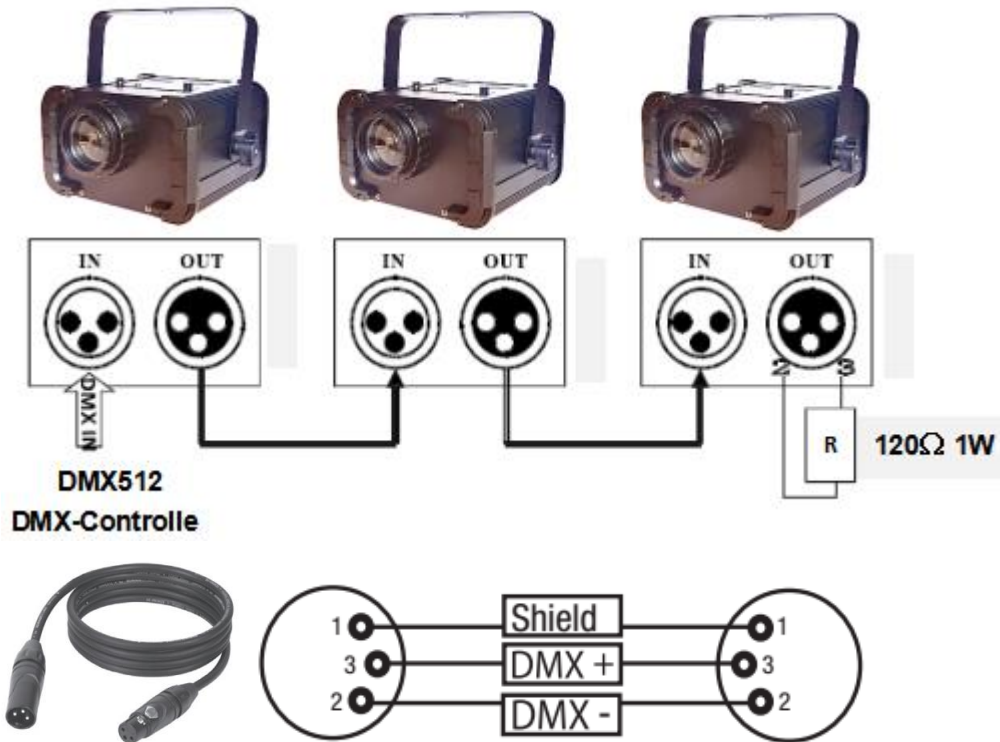

## VI. LED display instruction

➤ Press “MENU” button enter Menu, details as below.

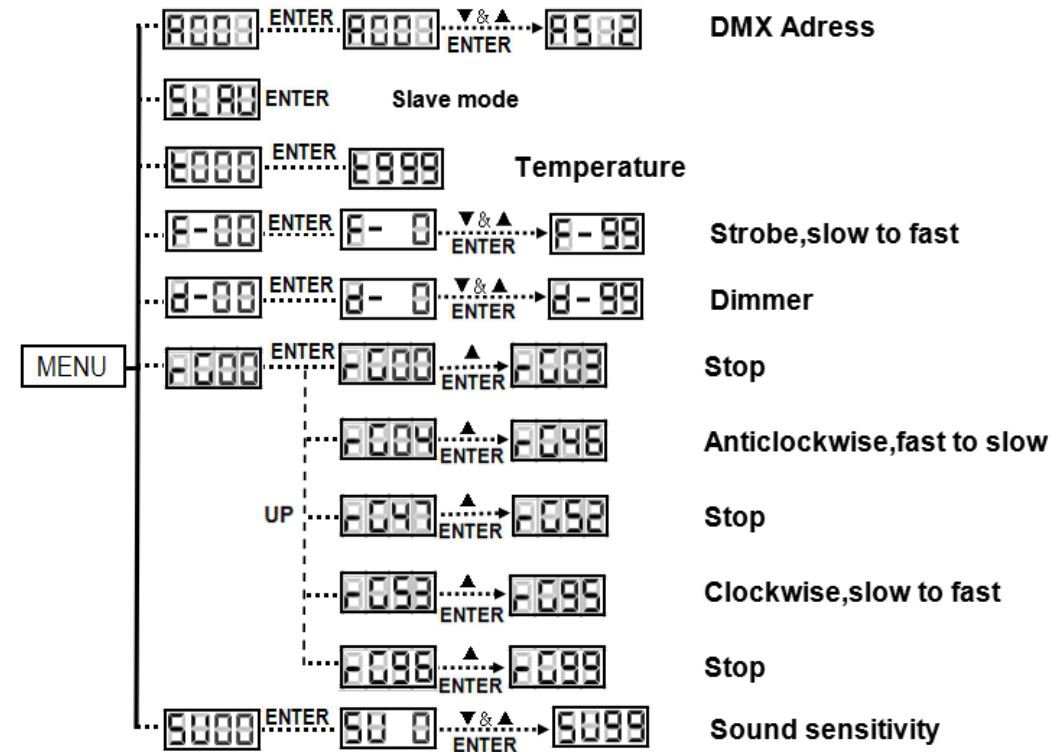

## VII. Manual setting

### 1. 8888 DMX512 address

Press “Menu” button,  $\nabla/\Delta$  to select “8888”, press **ENTER** button to enter address setting. Press  $\nabla/\Delta$  button to set the address, press **ENTER** to save your setting, then press **MENU** button exit.

### 2. 5888 Slave mode

Press “Menu” button,  $\nabla/\Delta$  to select “5888”, press **ENTER** button to save your setting, then press **MENU** button exit.

### 4. 2000 Temperature



Press “Menu” button,▽/Δto select “**E000**”,press **ENTER** button,led display will show the temperature. Press **MENU** button to exit.

5. **E-00 Strobe**

Press “Menu” button,▽/Δto select “**E-00**”,press **ENTER** button enter strobe function setting. Press▽/Δ button set F-1 to F-99,then press **ENTER** button to confirm. Press **MENU** button to exit.

6. **d-00 Dimmer**

Press “Menu” button,▽/Δto select “**d-00**”,press **ENTER** button enter dimmer setting. Press▽/Δ button set d-1to d-99,then press **ENTER** button to confirm. Press **MENU** button to exit.

7. **F000 Rotation**

Press “Menu” button,▽/Δto select “**F000**”,press **ENTER** button enter rotation function setting. Select suitable speed, then press **ENTER** button to confirm. Press **MENU** button to exit.

8. **S000 Sound sensitivity**

Press “Menu” button,▽/Δto select “**S000**”,press **ENTER** button enter sensitivity setting. Press▽/Δ button set sensitivity to be 0-99, then press **ENTER** button to confirm. Press **MENU** button to exit.

VIII. How to control the fixture

★Master/Slave

Set one fixture to be Master(**S000** or **E-00** ),set others to be Slave(**S000**),connect Master and Slave with DMX cable,Slaves will work with the Master.

★IR remote control

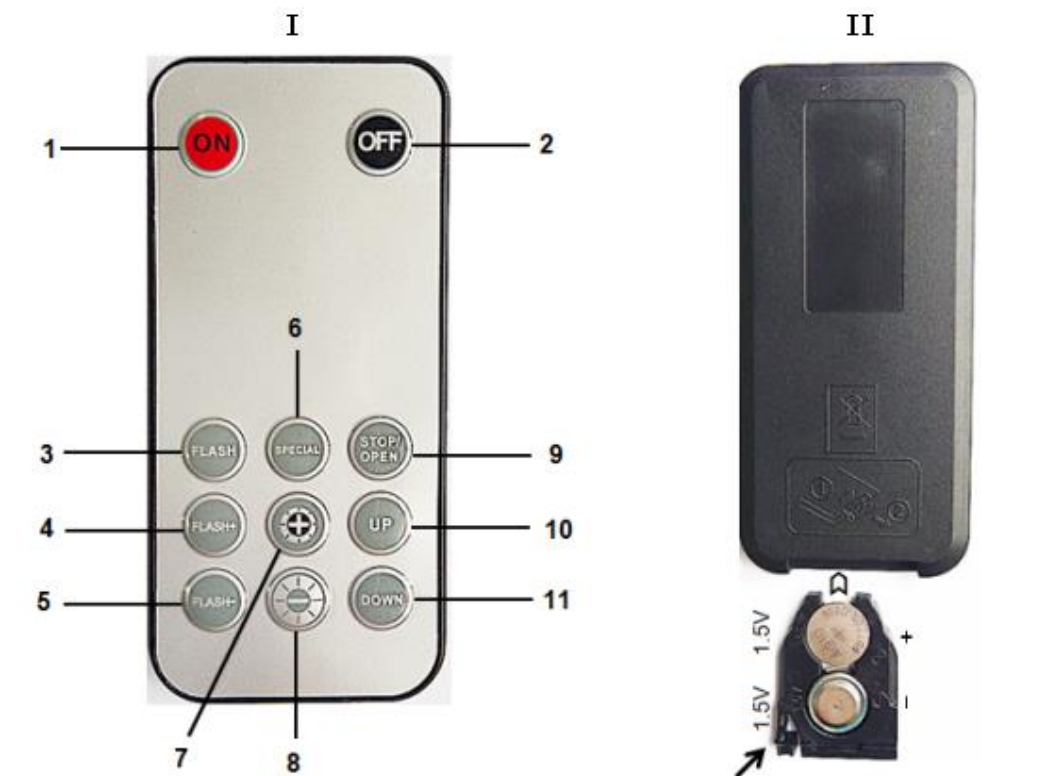

No.	Text	Function
1	ON	Turn On fixture
2	OFF	Turn Off fixture
3	FLASH	Strobe On/off
4	FLASH +	Strobe speed +
5	FLASH -	Strobe speed -
6	SPECIAL	Brightness
7	+	Brightness +
8	-	Brightness -
9	STOP/OPEN	Rotation function
10	UP	Rotation speed +
11	DOWN	Rotation speed -

★DMX Control

Please kindly reference the **IX.**